



Grange Avenue, North Finchley, N12

Offers In The Region Of £425,000



2



1



1



C



# Grange Avenue, North Finchley, N12



## Description

**\*\*GARDEN MAISONETTE\*\*** Homelink are delighted to offer for sale this well presented two bedroom ground floor maisonette.

The property benefits from a beautifully fitted modern kitchen with integrated dishwasher and fridge freezer, wonderfully tiled bathroom suite with washing machine, two well sized bedrooms, separate lounge and access to own rear garden. Additional benefits include gas central heating (untested), carpets in each room and own private front door.

Situated in this sought after location, within minutes' walk of North Finchley High Road and easy access to Woodside Park Tube Station (Northern line). The property is in fantastic condition and is ideal for a family or investors.

To arrange a viewing and to ensure you don't miss an amazing opportunity, call and speak to one of our friendly sales team. Call now to avoid disappointment.

Lease: c. 154 Years unexpired

Service Charge: NIL

Ground Rent - Peppercorn

Self Insured

Barnet C/Tax Band 'D'

NOTE: The photos shown were taken before the tenants occupation.

- Two Bedroom Maisonette
- Ground Floor with Garden
- Luxury Bathroom
- Modern Kitchen
- Local Schools and Parks
- Good Transport Links
- Local Amenities Close by
- Chain Free







Floor Plan

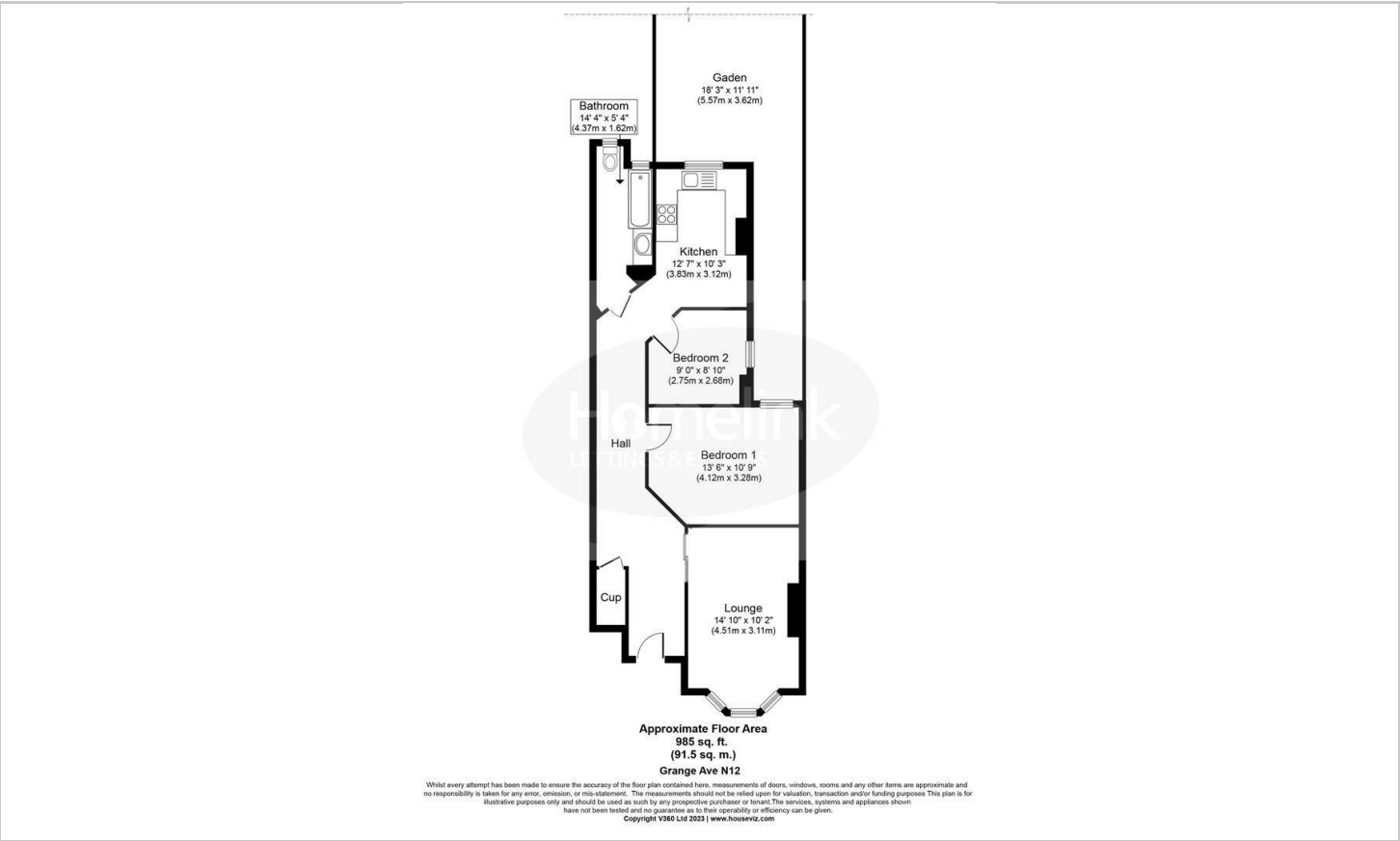

Area Map

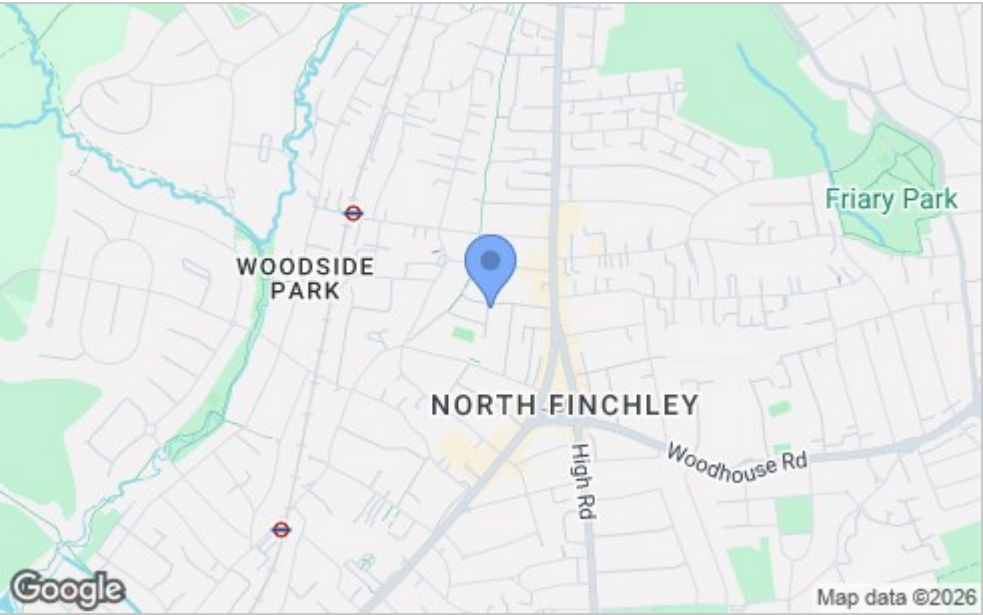

Viewing

Please contact our Homelink Lettings & Estates Office on 0208 882 2112 if you wish to arrange a viewing appointment for this property or require further information.

These particulars, whilst believed to be accurate are set out as a general outline only for guidance and do not constitute any part of an offer or contract. Intending purchasers should not rely on them as statements of representation of fact, but must satisfy themselves by inspection or otherwise as to their accuracy. No person in this firms employment has the authority to make or give any representation or warranty in respect of the property.

Energy Efficiency Graph

